

# MORTICE LOCKS

We stock Hardware and Security Products from all the leading brands and in a variety of finishes. We also have access to a huge range of products not listed here that we can source for you. Most special order items will arrive in a couple of days. The products listed below vary in specification from 'light use' applications to more heavy duty usage. Please ask if you require further advice.

## WINDSOR STANDARD EURO MORTICE LOCKS



### 45mm Backset; Case Size 66mm

Code	Finish	Availability
<b>1114SS</b>	Stainless Steel	<b>in stock*</b>
<b>1114PB</b>	Polished Brass	<b>in stock*</b>
<b>1114AB</b>	Antique Bronze	2-3 days
<b>1114NB</b>	Natural Bronze	2-3 days

### 57mm Backset; Case Size 78mm

Code	Finish	Availability
<b>1115SS</b>	Stainless Steel	<b>in stock*</b>
<b>1115PB</b>	Polished Brass	<b>in stock*</b>
<b>1115AB</b>	Antique Bronze	2-3 days
<b>1115NB</b>	Natural Bronze	2-3 days

**\*in stock:** Please note that until the Windsor product arrives in stock, a substitute brand may be offered

## WINDSOR 85mm EURO MORTICE LOCKS



### 45mm Backset; Case Size 71mm

Code	Finish	Availability
<b>1142SS</b>	Stainless Steel	2-3 days
<b>1142PB</b>	Polished Brass	2-3 days
<b>1142AB</b>	Antique Bronze	7-10 days
<b>1142NB</b>	Natural Bronze	7-10 days

### 60mm Backset; Case Size 86mm

Code	Finish	Availability
<b>1143SS</b>	Stainless Steel	2-3 days
<b>1143PB</b>	Polished Brass	2-3 days
<b>1143AB</b>	Antique Bronze	7-10 days
<b>1143NB</b>	Natural Bronze	7-10 days

## WINDSOR 85mm NARROW BACKSET EURO MORTICE LOCKS



### 30mm Backset; Case Size 47mm

Code	Finish	Availability
<b>1226SS</b>	Stainless Steel	2-3 days
<b>1226PB</b>	Polished Brass	2-3 days
<b>1226AB</b>	Antique Bronze	7-10 days
<b>1226NB</b>	Natural Bronze	7-10 days

### 35mm Backset; Case Size 52mm

Code	Finish	Availability
<b>1226SS</b>	Stainless Steel	2-3 days
<b>1226PB</b>	Polished Brass	2-3 days
<b>1226AB</b>	Antique Bronze	7-10 days
<b>1226NB</b>	Natural Bronze	7-10 days

## HEAVY DUTY WINDSOR ROLLER LOCKS



### 45mm Backset; Case Size 65mm

Code	Finish	Availability
<b>1139SS</b>	Stainless Steel	2-3 days
<b>1139PB</b>	Polished Brass	2-3 days

### 57mm Backset; Case Size 78mm

<b>1140SS</b>	Stainless Steel	2-3 days
<b>1140PB</b>	Polished Brass	2-3 days

## WINDSOR BATHROOM LOCKS



### 45mm Backset; Case Size 65mm

Code	Finish	Availability
<b>1110PC</b>	Polished Chrome	2-3 days
<b>1110PB</b>	Polished Brass	2-3 days

### 57mm Backset; Case Size 78mm

<b>1136PC</b>	Polished Chrome	2-3 days
<b>1136PB</b>	Polished Brass	2-3 days

## WINDSOR SLIDING EURO LOCK CASE



### 50mm Backset

Code	Finish	Availability
<b>1110SS</b>	Stainless Steel	2-3 days
<b>1110PC</b>	Polished Chrome	2-3 days

We stock Hardware and Security Products from all the leading brands and in a variety of finishes. We also have access to a huge range of products not listed here that we can source for you. Most special order items will arrive in a couple of days. The produc

**WINDSOR EURO PROFILE DOUBLE KEY CYLINDERS**



Code	Finish	Size	Availability	Code	Finish	Size	Availability
<b>1121PB</b>	Polished Brass	60mm	<b>in stock*</b>	<b>1222PB</b>	Polished Brass	80mm	2-3 days
<b>1121SC</b>	Satin Chrome		<b>in stock*</b>	<b>1222SC</b>	Satin Chrome		2-3 days
<b>1121AB</b>	Antique Bronze		2-3 days	<b>1222SC</b>	Antique Bronze		2-3 days
<b>1147PB</b>	Polished Brass	70mm	2-3 days	<b>1224PB</b>	Polished Brass	90mm	2-3 days
<b>1147SC</b>	Satin Chrome		2-3 days	<b>1224SC</b>	Satin Chrome		2-3 days
<b>1147AB</b>	Antique Bronze		2-3 days	<b>1224SC</b>	Antique Bronze		2-3 days

\*in stock: Please note that until the Windsor product arrives in stock, a substitute brand may be offered

**WINDSOR EURO PROFILE CYLINDER TURNS**

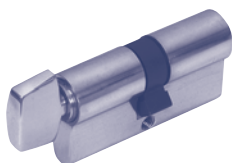

Code	Finish	Size	Availability	Code	Finish	Size	Availability
<b>1122PB</b>	Polished Brass	60mm	<b>in stock*</b>	<b>1223PB</b>	Polished Brass	80mm	2-3 days
<b>1122SC</b>	Satin Chrome		<b>in stock*</b>	<b>1223SC</b>	Satin Chrome		2-3 days
<b>1122AB</b>	Antique Bronze		2-3 days	<b>1223SC</b>	Antique Bronze		2-3 days
<b>1148PB</b>	Polished Brass	70mm	2-3 days	<b>1225PB</b>	Polished Brass	90mm	2-3 days
<b>1148SC</b>	Satin Chrome		2-3 days	<b>1225SC</b>	Satin Chrome		2-3 days
<b>1148AB</b>	Antique Bronze		2-3 days	<b>1225SC</b>	Antique Bronze		2-3 days

**5 LEVER MORTICE LOCKS**



45mm Backset; Case Size 65mm			45mm Backset; Case Size 65mm		
Code	Finish	Availability	Code	Finish	Availability
<b>1107PB</b>	Polished Brass	<b>in stock*</b>	<b>1108PB</b>	Polished Brass	<b>in stock*</b>
<b>1107CP</b>	Polished Chrome	<b>in stock*</b>	<b>1108CP</b>	Polished Chrome	<b>in stock*</b>
<b>1107AB</b>	Antique Bronze	7-10 days	<b>1108AB</b>	Antique Bronze	7-10 days
<b>1107BLK</b>	Black	7-10 days	<b>1108BLK</b>	Black	7-10 days

**3 LEVER MORTICE LOCKS**



45mm Backset; Case Size 65mm			45mm Backset; Case Size 65mm		
Code	Finish	Availability	Code	Finish	Availability
<b>1103SS</b>	Stainless Steel	<b>in stock*</b>	<b>1104SS</b>	Stainless Steel	<b>in stock*</b>
<b>1103PB</b>	Polished Brass	<b>in stock*</b>	<b>1104PB</b>	Polished Brass	<b>in stock*</b>
<b>1103AB</b>	Antique Bronze	7-10 days	<b>1104AB</b>	Antique Bronze	7-10 days
<b>1103BLK</b>	Black	7-10 days	<b>1104BLK</b>	Black	7-10 days

**TUBULAR LATCHES**



**45mm Backset**

Code	Finish	Availability
<b>DTL25PB</b>	Polished Brass	<b>in stock</b>
<b>DTL25NP</b>	Nickel PLate	<b>in stock</b>

**60mm Backset**

Code	Finish	Availability
<b>G480PB</b>	Polished Brass	<b>in stock</b>
<b>G480SC</b>	Satin Chrome	<b>in stock</b>
<b>G480FB</b>	Florentine Bronze	<b>in stock</b>

**70mm Backset**

Code	Finish	Availability
<b>G481PB</b>	Polished Brass	<b>in stock</b>
<b>G481SC</b>	Satin Chrome	<b>in stock</b>
<b>G481FB</b>	Florentine Bronze	<b>in stock</b>